

## SIRIUS HRI 190 W+

SIRIUS HRI | Metal halide lamps



### Areas of application

- Perfect for small and lightweight moving heads

### Product benefits

- High luminance due to very short arc and high internal pressure
- Bright light for brilliant light effects
- Long lifetime
- Lightweight and compact reflector lamps with ECG
- Optimized burner design allows any burning position
- Easy relamping
- Uniform light output throughout the entire lifetime



Technical data

Electrical data

Nominal wattage	190.00 W
Nominal current	2.7 A

Photometrical data

Nominal luminous flux	8100 lm
Color temperature	8200 K
Color rendering index Ra	73

Dimensions & weight

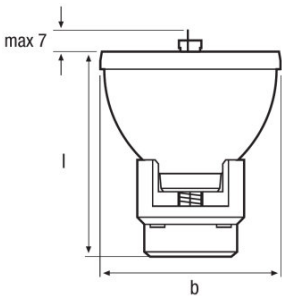

Diameter	51.0 mm
Length	62.5 mm
Arc length	0.8 mm

Lifespan

Lifespan	3000 h
----------	--------

Capabilities

Burning position	Any
------------------	-----

## Product datasheet

---

### Safety advice

Because of their high luminance, UV radiation and high internal pressure during operation, SIRIUS HRI lamps may only be operated in enclosed lamp casings specially constructed for the purpose. Appropriate filters must ensure that UV radiation is reduced to an acceptable level. Mercury is released if the lamp breaks. Special safety precautions must be taken. Information on safety and handling is available on request or can be found in the leaflet included with the lamp or in the operating instructions.

---

### Disclaimer

Subject to change without notice. Errors and omission excepted. Always make sure to use the most recent release.